



**PT. GUNUNG BAJA KONSTRUKSI**  
steel construction is our business



**INSPIRECHANGE  
CREATEGROWTH  
BUILDGREEN**



*Company Profile*

[www.gunungbaja.com](http://www.gunungbaja.com)

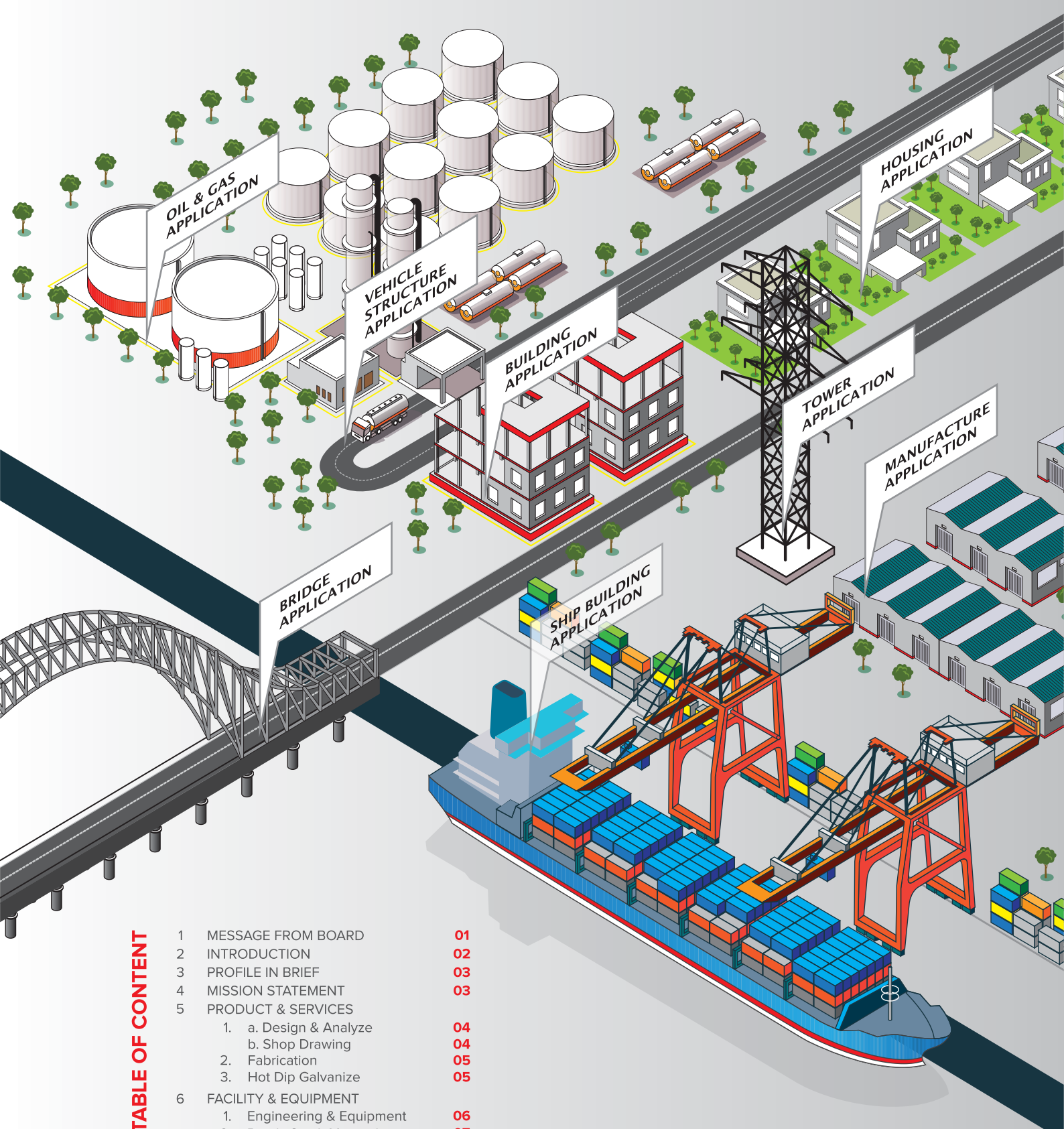

**TABLE OF CONTENT**

1	MESSAGE FROM BOARD	01
2	INTRODUCTION	02
3	PROFILE IN BRIEF	03
4	MISSION STATEMENT	03
5	PRODUCT & SERVICES	
1.	a. Design & Analyze	04
	b. Shop Drawing	04
2.	Fabrication	05
3.	Hot Dip Galvanize	05
6	FACILITY & EQUIPMENT	
1.	Engineering & Equipment	06
2.	Ready Stock Material	07
3.	Profile Service Center Plant	08
4.	Plate Service Center Plant	09
5.	Welded Beam	10
6.	Assembling & Welding	11
7.	Trial Erection	12
8.	Shootblasting & Painting	13
9.	Hot Dip Galvanizing	14
10.	Packing & Loading	18
7	QC LABORATORIUM	20
	QUALITY CONTROL	21
8	PROJECT EXPERIENCE	22
9	STANDARD CERTIFICATE	35
10	OUR CLIENT	36
11	LOCATION MAP	37





**“Thank you for choosing PT. Gunung Baja Konstruksi as the solution to your building design requirements / engineering building and galvanizing processes of your steel.”**

More than 22 years experience in this industry, our company has grown and evolved to meet the needs of building design / engineering, where it is in line with our continued efforts to support the advancement of the nation's of Indonesia better in the future.

We always insist on the quality and professional performance. In depth experience and is accompanied by a comprehensive approach, it is our endeavor to provide the best service and value-added of a product. Through these efforts, we were able to maintain its position as a leading company in the construction industry.

At PT. Gunung Baja Konstruksi, we always foster continuous improvement value through the achievement and progress, which is characterized by the development in all areas of the progressive and responsive. We also continued to learn and join hands with business partners to grow and develop together.

As a final word, we as a company that continues to grow and evolve, hoping for their support and participation of all business partners in order to achieve long-term cooperation.

Melalui pengalaman lebih dari 22 tahun dalam industri ini, perusahaan kami telah tumbuh berkembang memenuhi kebutuhan rancang bangun / rekayasa, dimana hal tersebut sejalan dengan upaya kami untuk terus mendukung kemajuan bangsa Indonesia yang lebih baik di masa depan.

Kami selalu menekankan dan mengutamakan kualitas performa profesional. Pengalaman yang mendalam dan disertai dengan pendekatan komprehensif, adalah upaya kami untuk memberikan layanan serta nilai tambah terbaik dari sebuah produk. Melalui upaya ini, kami mampu mempertahankan posisi sebagai perusahaan terkemuka di industri konstruksi.

Di PT. Gunung Baja Konstruksi, kami selalu memupuk nilai penyempurnaan terus menerus melalui pencapaian dan kemajuan, yang ditandai dengan pengembangan di semua bidang secara progresif dan responsif. Kami juga terus melakukan pembelajaran serta bergandeng tangan dengan seluruh mitra bisnis untuk dapat tumbuh dan berkembang bersama.

Sebagai kata penutup, kami sebagai perusahaan yang terus tumbuh dan berkembang, berharap atas dukungan dan partisipasi seluruh rekan bisnis demi tercapainya kerjasama jangka panjang.



**PT. GUNUNG BAJA KONSTRUKSI** is a member of **GUNUNG STEEL GROUP** the parent of company.

(PT. Gunung Garuda, PT. Gunung Raja Paksi & PT. Gunung Gahapi Sakti)

With full support of the Gunung Steel Group as the holding company, PT. Gunung Baja Konstruksi significantly participate in the development in Indonesia by providing services Design Build / Engineering, Design Construction, Fabrication and Galvanizing International Class.

Powered by professional experts and used of the latest machinery and technology to our strong commitment, PT. Gunung Baja Konstruksi is a necessary asset and is part of the development of the steel industry in Indonesia, in the fields Manufacture Steel and Hot Dip Galvanizing.

**PT. GUNUNG BAJA KONSTRUKSI** adalah anggota dari **GUNUNG STEEL GROUP** yang merupakan induk perusahaan.

(PT. Gunung Garuda, PT. Gunung Raja Paksi & PT. Gunung Gahapi Sakti)

Dengan dukungan penuh dari Gunung Steel Group sebagai induk perusahaan, kami PT. Gunung Baja Konstruksi secara nyata turut berpartisipasi dalam pembangunan di Indonesia dengan menyediakan Jasa Rancang Bangun / Rekayasa, Desain, Konstruksi, Fabrikasi dan Jasa Pencelupan (Galvanizing) yang berkelas Internasional.

Didukung oleh tenaga - tenaga ahli yang profesional dengan penggunaan teknologi mesin terbaru serta komitmen kami yang kuat, PT. Gunung Baja Konstruksi merupakan asset yang diperlukan dan bagian dari perkembangan industri baja di Indonesia, dalam bidang Manufaktur Baja dan Galvanis.

**1997** Established  
as galvanizing service & engineering service center (ESC)

**PT. BUKIT TERANG PAKSI GALVANIZING**

**2012** Merger Division  
PT. Gunung Raja Paksi / PT. Gunung Garuda (ESC division)

**PT. GUNUNG STEEL CONSTRUCTION**

**2017** Re-naming  
changed rename PT. Gunung Steel Construction to :

**PT. GUNUNG BAJA KONSTRUKSI**

Established in **1997** Under the name **PT. Bukit Terang Paksi Galvanizing** as service company based dyeing services (Galvanizing), we fused together with the Division of **Engineering Service Center (ESC)**, PT. Gunung Raja Paksi / PT. Gunung Garuda in a new venture that is **PT. Gunung Steel Construction** in **2012** with the Division of Engineering Fabrication, Construction and Galvanizing Division. In **2017** PT. Gunung Steel Construction changed its name to **PT. GUNUNG BAJA KONSTRUKSI**. These changes along with the development of national industry in Indonesia.

Berdiri tahun **1997** dengan nama **PT. Bukti Terang Paksi Galvanizing** sebagai perusahaan yang berbasis jasa pencelupan (Galvanizing), kami melebur menjadi satu dengan Divisi **Engineering Service Center (ESC)**, PT. Gunung Raja Paksi / PT. Gunung Garuda dalam satu wadah baru yaitu **PT. Gunung Steel Construction** pada tahun **2012** dengan Divisi Engineering Fabrication Construction dan Divisi Galvanizing. Di tahun **2017** PT. Gunung Steel Construction berubah nama menjadi **PT. GUNUNG BAJA KONSTRUKSI**. Perubahan ini seiring dengan perkembangan industri nasional di Indonesia.





# PT. GUNUNG BAJA KONSTRUKSI

steel construction is our business

<b>COMPANY NAME</b>	<b>TYPE OF BUSINESS</b>
PT. GUNUNG BAJA KONSTRUKSI	1. ENGINEERING 2. FABRICATION 3. CONSTRUCTION 4. HOT DIP GALVANIZING
<b>COMPANY MOTTO</b>	<b>NUMBER OF EMPLOYEES</b>
steel construction is our business	500 people
<b>MEMBER OF</b>	<b>PRODUCTION CAPACITY</b>
Gunung Steel Group	Engineering Fabrication Construction (EFC) Plant : 60.000 MT / Year Hot Dip Galvanizing (GALV) Plant : 42.000 MT / Year
<b>OFFICE ADDRESS</b>	<b>EMAIL</b>
GBK Building, Jl. Raya Jarakosta, Prapatan Ne'ih, RT 007 / 004 Sukadanau, West Cikarang - Bekasi 17843 West Java - INDONESIA	sales.esc@grdsteel.com sales.gsc-efc@grdsteel.com sales.gsc-galv@grdsteel.com
<b>OFFICE CONTACT</b>	
Phone : +6221 8983 8121   8983 8111 Fax : +6221 8910 8031 Website : www.gunungbaja.com	

## MISSION STATEMENT

### VISION

Become a company that can contribute in the areas of construction, fabrication and galvanizing services with international standard and the best in their field.

### MISSION

Become a trusted company in their field, can be proud to provide quality products and services with continuous innovation in order to achieve customer satisfaction.

### VISI

Menjadi perusahaan yang dapat memberikan kontribusi dalam bidang konstruksi, fabrikasi dan jasa galvanis berskala internasional dan terbaik di bidangnya.

### MISI

Menjadi perusahaan yang terpercaya, dapat dibanggakan dengan menyediakan produk dan jasa yang berkualitas serta berinovasi demi mencapai kepuasan pelanggan.



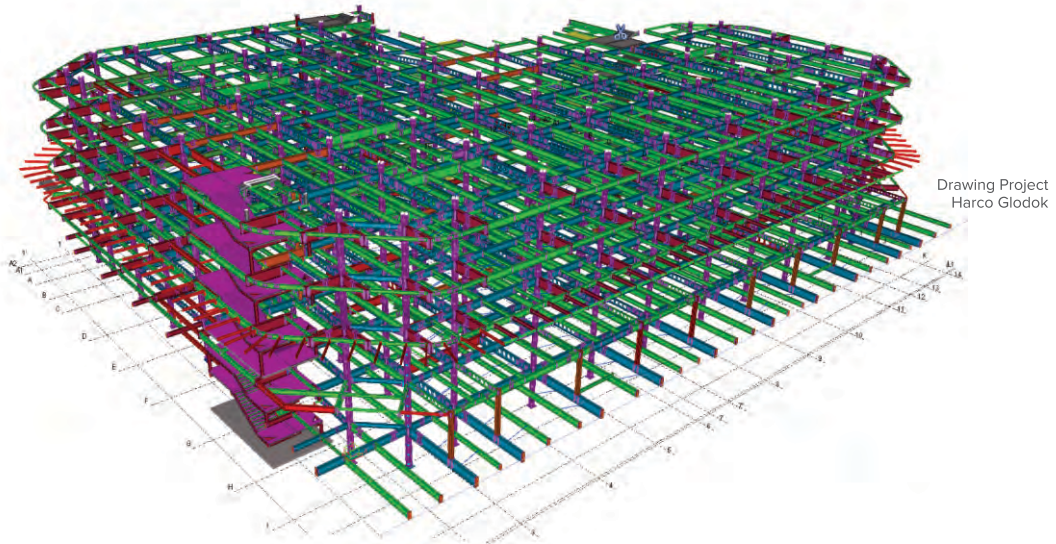

Drawing Project Harco Glodok

## 1. DESIGN & ANALYZE

Since 1997, PT. Gunung Baja Konstruksi already using some a design software in a various all projects such as Auto CAD, STAAD Pro, X-Steel, Steel CAD and Tekla software where every year is always update to follow the development era to the present in order to produce the best quality and market demands.

Sejak tahun 1997, PT. Gunung Baja Konstruksi sudah menggunakan beberapa perangkat lunak rekayasa dalam berbagai proyek seperti perangkat lunak Auto CAD, STAAD Pro, X-Steel, Steel CAD dan Tekla dimana setiap tahun selalu memperbaharunya mengikuti perkembangan jaman hingga saat ini demi menghasilkan kualitas terbaik dan tuntutan pasar.

## 2. SHOP DRAWING

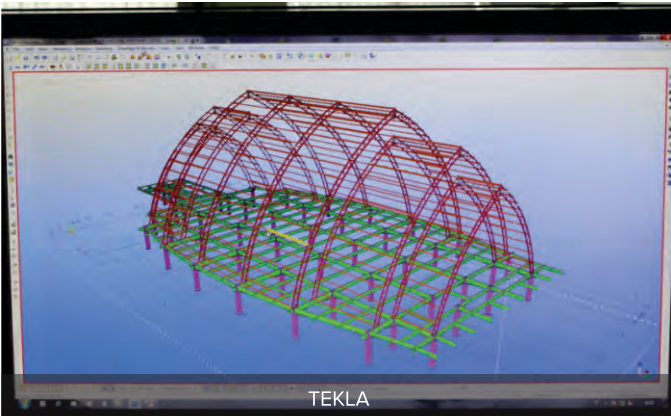

TEKLA

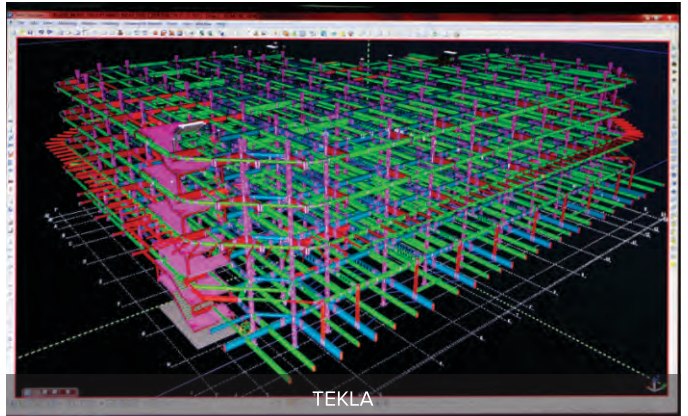

TEKLA

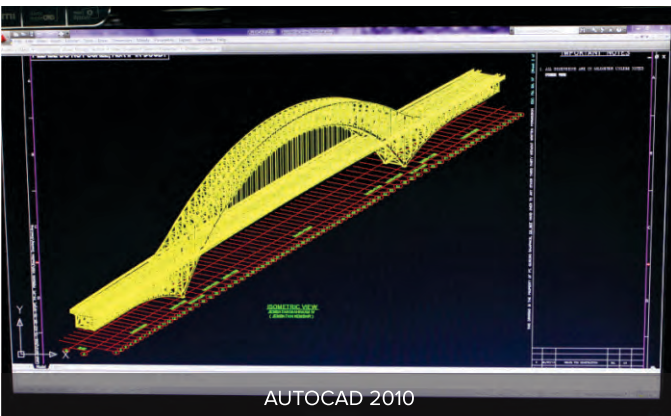

AUTOCAD 2010

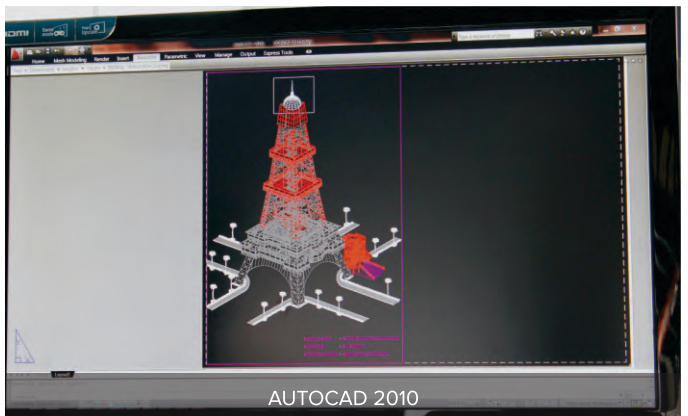

AUTOCAD 2010





PROYEK JEMBATAN PELENGKUNG TELUK MASJID | RIAU - INDONESIA

### 3. FABRICATION

PT. Gunung Baja Konstruksi engaged in the Engineering Fabrication Construction and Hot Dip Galvanizing to have a wide range of superior products such as a bridge, building, tower and galvanizing.

PT. Gunung Baja Konstruksi bergerak di bidang Engineering Fabrication Construction and Hot Dip Galvanizing dengan memiliki berbagai macam produk unggulan seperti jembatan, building, tower dan galvanizing.



FABRICATION ACTIVITIES

### 4. HOT DIP GALVANIZE



GALVANIZING ACTIVITIES



GALVANIZE PROCESS



DIPPING GALVANIZE



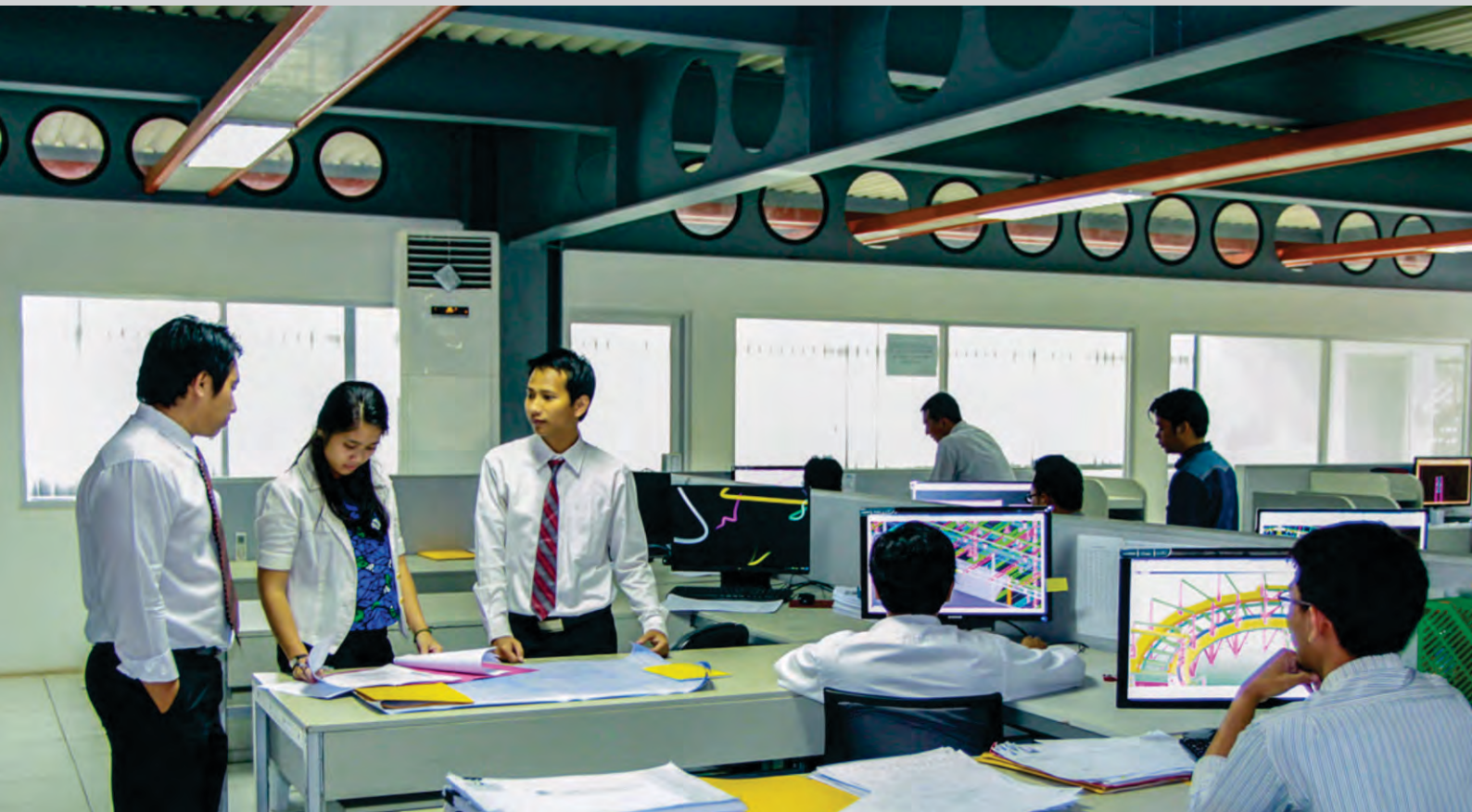

## 1. ENGINEERING TEAM & EQUIPMENT

In all our activities are supported by the Ready Stock Material, Fabrication Machine with Computerized Numerical Control (CNC), Software (AutoCAD, STAAD III, X-Steel, Tekla CAD & Steel), Fabrication Workshop Area (60.000 MT / year), Galvanizing Workshop Area (42.000 MT / year), Quality Control, as well as other support machines.

Dalam setiap kegiatan, kami di dukung dengan Ready Stock Material, Mesin Fabrikasi dengan sistem Computerized Numeric Control (CNC), perangkat lunak (AutoCAD, STAAD III, X\_Steel, Steel CAD & Tekla), Area Workshop Fabrikasi (60.000 MT / tahun), Area Workshop Galvanizing (42.000 MT / tahun), Quality Control, serta mesin-mesin pendukung lainnya.

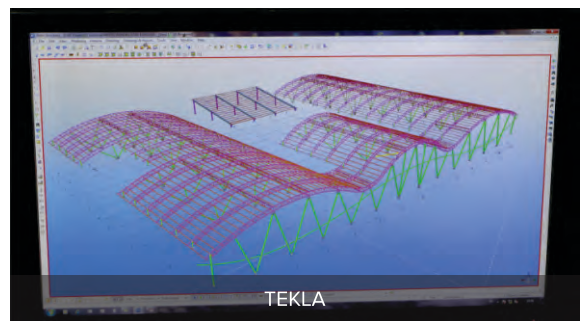

TEKLA

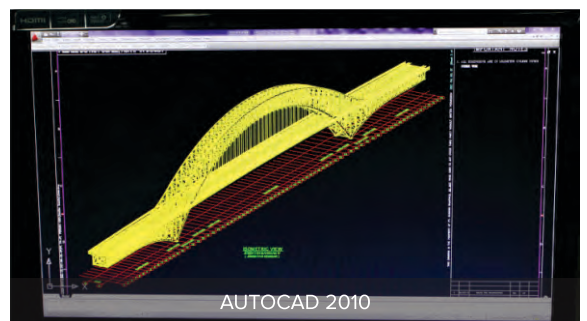

AUTOCAD 2010



SCANNER OCE 9400



PRINTER OCE 9400



PRINTER XEROX DOCUCENTRE



## 2. READY STOCK MATERIAL



STOCK YARD IWF & H-BEAM

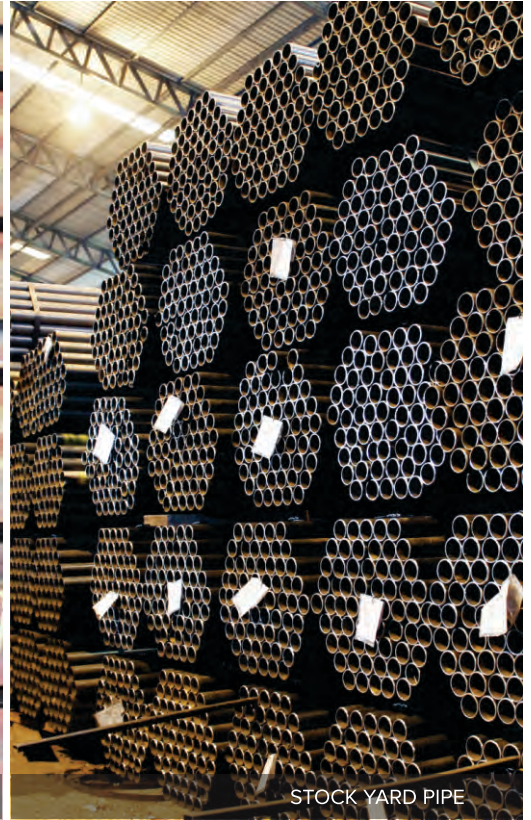

STOCK YARD PIPE

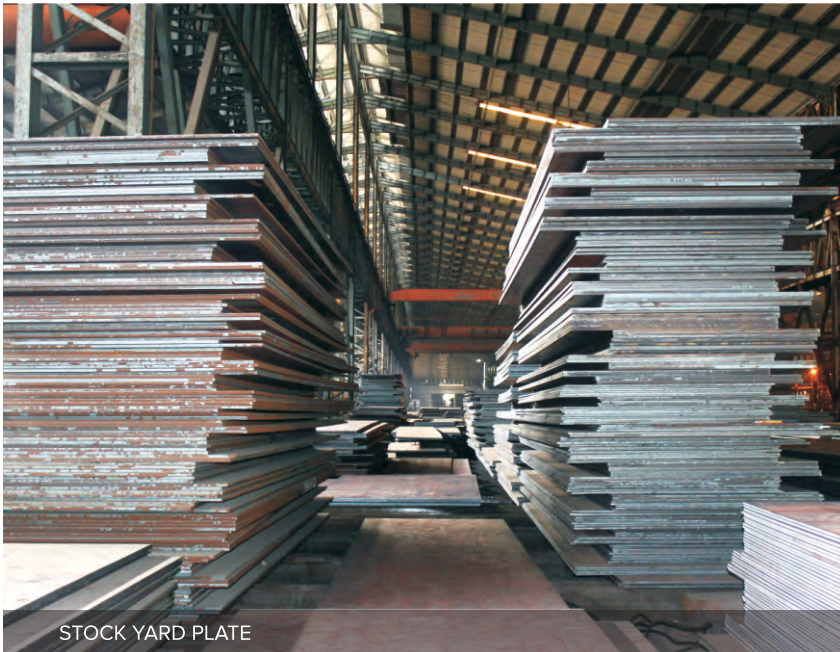

STOCK YARD PLATE



STOCK YARD SPIRAL PIPE



STOCK YARD EXPANDED



STOCK YARD ANGLE



STOCK YARD LIPPED CHANNEL



### 3 PROFILE SERVICE CENTER PLANT



PLANT PROFILE SERVICE CENTER

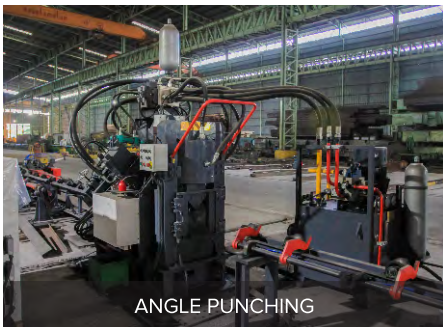

ANGLE PUNCHING



MULTI DRILL & SAW MACHINE



HYDRAULIC MACHINE



BAND SAW CUTTING MACHINE



FICER DRILLING MACHINE



DRILLING MACHINE



DRILLING MACHINE



STRAIGHTENING MACHINE





PLANT PLATE SERVICE CENTER



PEDDINGHAUS MACHINE



ANGLE PUNCHING MACHINE



PLASMA CUTTING & DRILLING



OXY ESAB CUTTING



FLAT BAR PUNCHING MACHINE



5 WELDED BEAM



WELDED BEAM PLANT



TACK WELDING MACHINE



WELDED BEAM



BENDING MACHINE



WELDED BEAM



WELDED BEAM



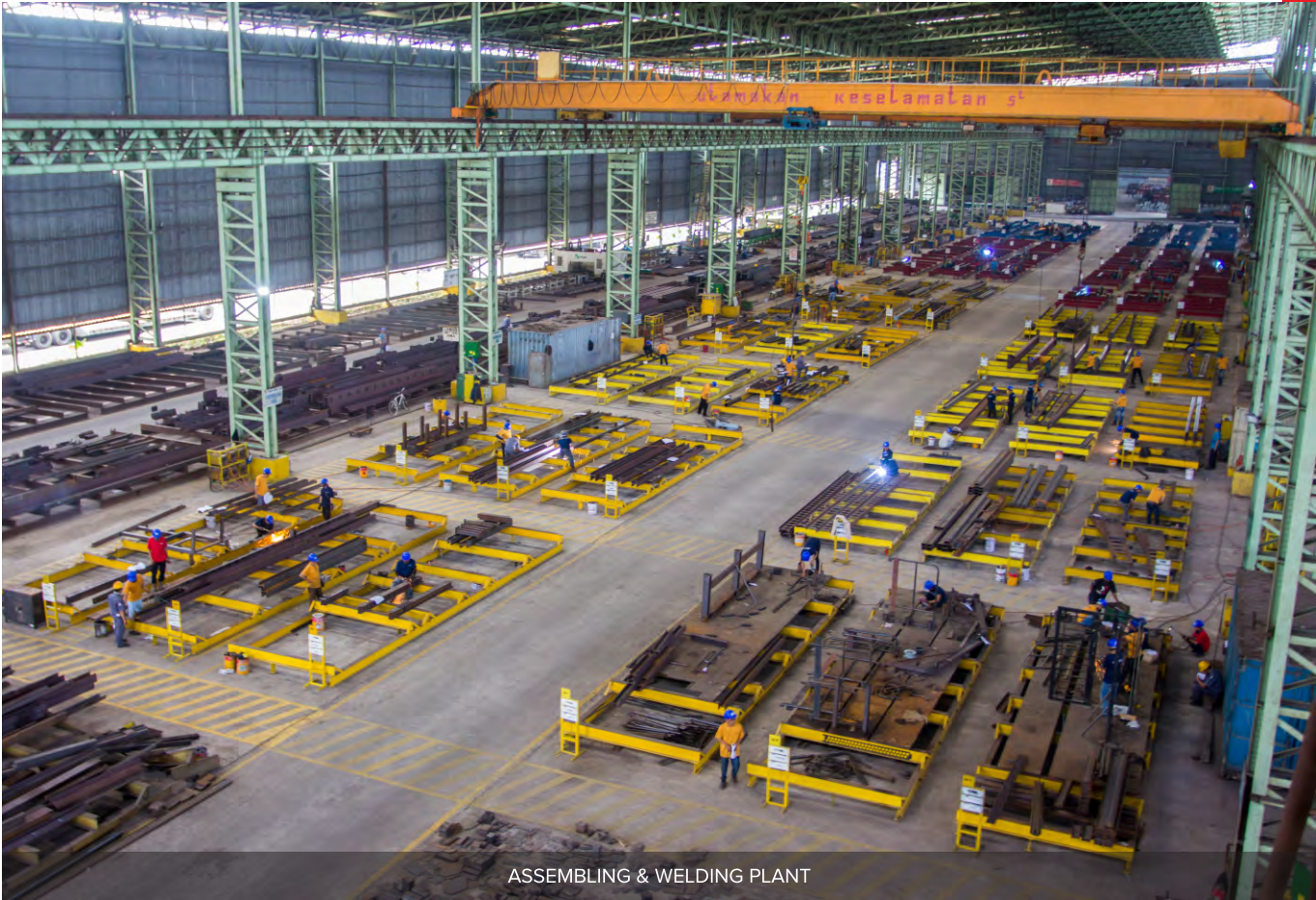

ASSEMBLING & WELDING PLANT

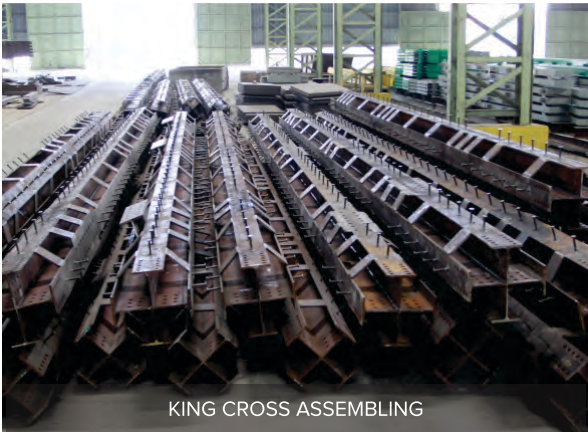

KING CROSS ASSEMBLING



ASSEMBLING STATION PROJECT

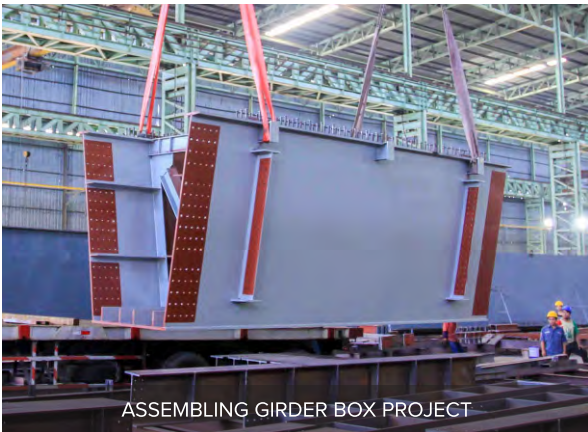

ASSEMBLING GIRDER BOX PROJECT



ASSEMBLING GIRDER BOX PROJECT



7 TRIAL ERECTION AREA



TRIAL ERECTION TRUSS BRIDGE PUPR - 2017



TRIAL ERECTION TOWER PLN - 2017

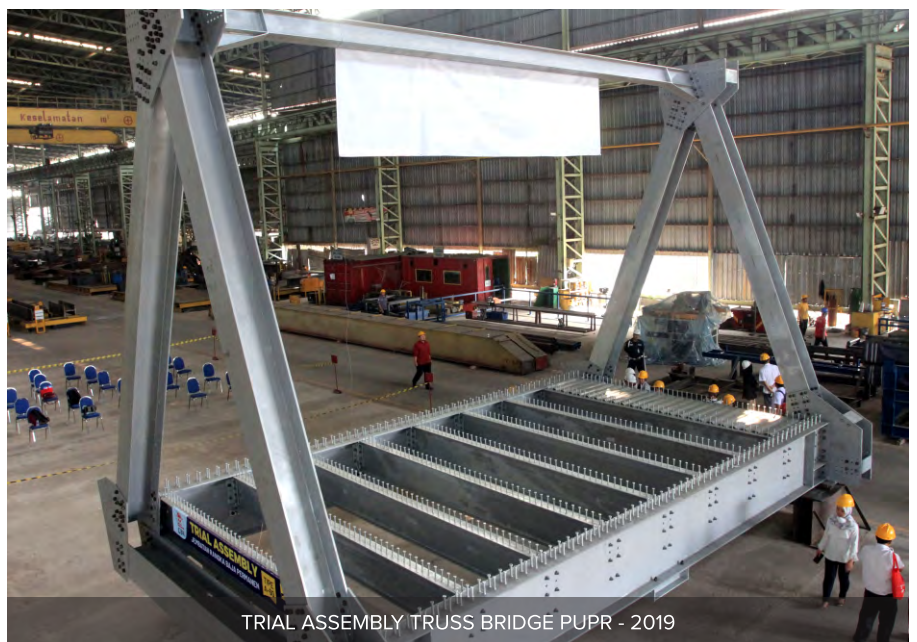

TRIAL ASSEMBLY TRUSS BRIDGE PUPR - 2019



TRIAL ERECTION GIRDER BRIDGE - 2019







## HOT DIP GALVANIZING

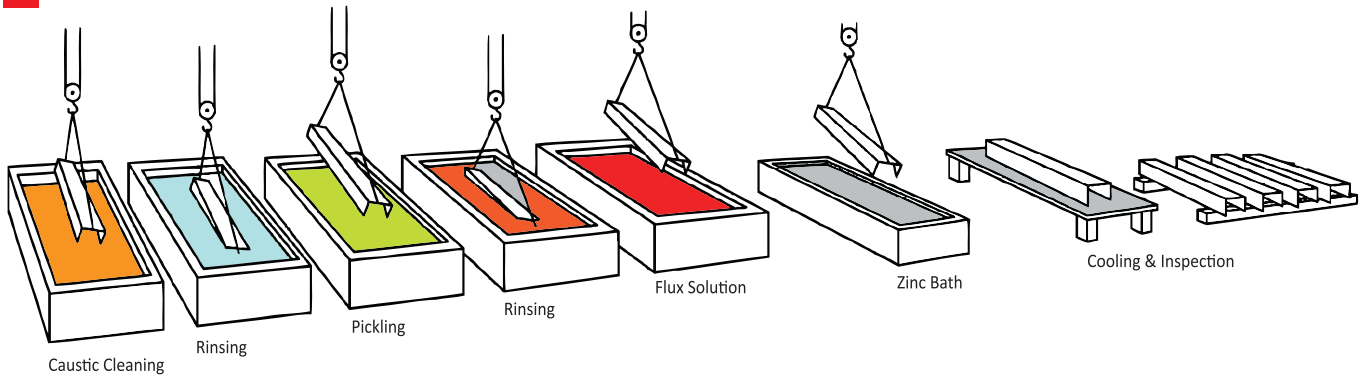

### Why Galvanizing ?

Galvanizing steel products can provide the steel the protection from corrosive reaction when the steel products are getting exposed to open air. It will also reduce the total maintenance expenses over the life time of the steel when compared to steel not treated with galvanized process.

### Characteristics:

- Corrosion resistant (the galvanizing layer prevents rust for decades)
- Abrasion and impact resistant (zinc alloy layers are harder than base steel)
- Cathodic protection (a slightly damaged galvanized layer can still protect exposed steel from corrosion).

### Mengapa Galvanisasi ?

Baja galvanis merupakan produk baja yang memiliki lapisan yang dapat melindunginya dari reaksi korosi ketika baja terkena udara terbuka. Ini akan mengurangi biaya perawatan selama baja digunakan, bila dibandingkan dengan baja yang tidak dilindungi dengan proses galvanis.

### Karakteristik :

- Anti Karat (lapisan galvanis mencegah karat selama bertahun-tahun)
- Tahan Abrasi (terkikis) dan benturan (lapisan campuran zinc lebih kokoh dari baja biasa).
- Pelindung Katode (lapisan galvanisir yang mulai rusak masih mampu melindungi baja dari karat).

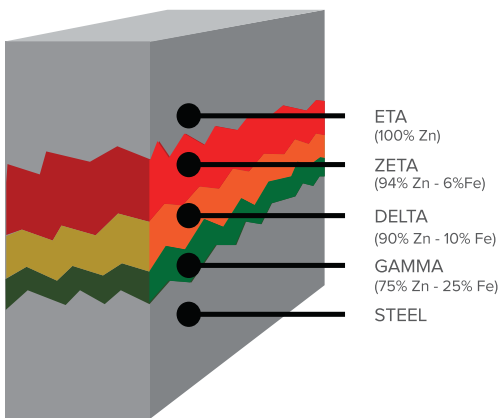

### Hot Dip Galvanizing Coatings

Coating Life in Typical Environments  
Based on typical hot dip galvanized coating thickness of 90 - 100 microns on structural steel

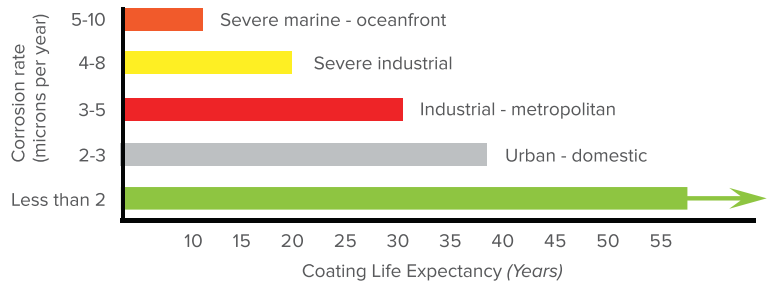

ATMOSPHERIC ENVIRONMENT		CORROSION RATE / YEAR	
VILLAGE SETTLEMENT	: Dry < 600mm rain / year	1 - 2	Microns
TROPICAL INDUSTRIAL	: Non Industrial > 600mm rain / year	2 - 3	Microns
INDUSTRIAL	: > 1000 mm rain / year, high average humidity	5 - 8	Microns
INDUSTRIAL	: External	3 - 5	Microns
INDUSTRIAL	: Internal (Fumes, Vapour, Steam)	5 - 8	Microns
BEACH	: 100 - 500 meter from the edge of the sea	5 - 8	Microns
MARINE	: Seafront	8 - 15	Microns

GALVANIZED TUB CAPACITY   KAPASITAS BAK GALVANIS		
PANJANG (LENGTH) <b>12.5 METER</b>	LEBAR (WIDTH) <b>1.8 METER</b>	TINGGI (HEIGHT) <b>2.6 METER</b>



Our Commitment :

**“To Provide  
Excellent Quality  
Service and  
Innovation”**



9 HOT DIP GALVANIZING PLANT

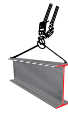

**Preparing (Persiapan)**  
Mempersiapkan material untuk di proses

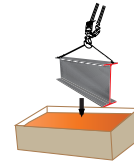

**Degreasing dengan Soda Kauskatik (Na OH)**  
Penghilang minyak, oli, karat, cat

HOT DIP GALVANIZING PROCESS

**PREPARING**  
(Persiapan)



This process is the process of preparing and arrangement of the material in a way linked to the positioning aids with slope of 45 degrees.

Proses ini adalah proses penyusunan dan penataan material dengan cara dikaitkan pada alat bantu dengan posisi kemiringan 45 derajat.

**DEGREASING**  
(Penghilang minyak, oli, dll)



This process is a process to eliminate oil, oil or grease, varnish and paint Caustic Soda (Na OH) on the use of materials Galvanized be done.

Proses ini adalah proses untuk menghilangkan minyak, oli/gemuk, vernis dan cat dengan menggunakan Soda Kausatik (Na OH) pada material yang akan dilakukan proses Galvanis.

**LOADING & TRUCKING**  
(Pengangkutan)



This process is the end of the production process, to further a process of drafting and arrangement of material on the vehicle.

Proses ini adalah akhir dari tahapan proses produksi, untuk selanjutnya dilakukan proses penyusunan dan penataan material diatas kendaraan.

**FINISHING**  
(Penyelesaian)



This process is a process of arranging material Hot Dip Galvanize process and removing remaining zinc needles.

Proses ini merapihkan material setelah di galvanis dan juga menghilangkan sisa jaruman zinc yang menempel di material.

**COOLING**  
(Pendinginan)



This process is the cooling material after the Dipping Process

Proses ini adalah mendinginkan material setelah dilakukannya proses Dipping. Proses ini biasanya dinamakan proses Quenching.

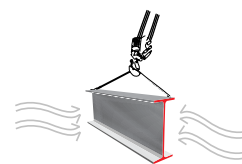
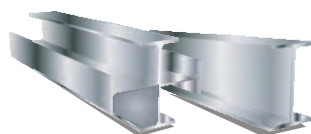
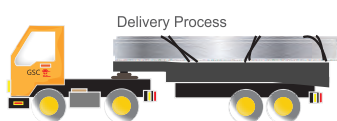

**Cooling (Pendinginan)**  
Proses pendinginan material setelah proses dipping



# GALVANIZING PROCESS



**Water Rinsing Pickling**  
Pembilasan dengan air dari sisa asam

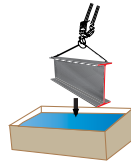

**Pickling (Penghilang Karat)**  
Penghilangan karat dengan Asam Klorida

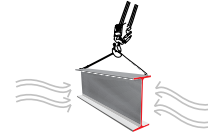

**Drying (Pengerinan)**  
Proses pengerinan material

## WATER RINSING DEGREASING

(Pembilasan dengan air dari proses degreasing)



This process is process of eliminating residual degreasing fluid.

Proses ini adalah proses menghilangkan sisa cairan degreasing.



## PICKLING

(Penghilangan karat)



This process is a cleaning process to remove rust attached to the material by using Chlorida Acid.

Proses ini adalah proses pembersihan untuk menghilangkan karat yang melekat pada material dengan menggunakan Asam Klorida.



## DRYING

(Pengerinan)



This is a process to eliminating residual liquids (cleaning of the remaining acid) from the pickling (preservation).

Proses ini adalah proses menghilangkan sisa cairan (pembersihan dari sisa asam) dari proses pickling.

## DIPPING

(Pencelupan)



This process is the process of dyeing material to Zinc in liquid hot, with temperatures 450-460 Degrees Celcius, so the whole zinc coated materials in metallurgy.

Proses ini adalah proses pencelupan material ke dalam cairan Zinc panas, dengan temperatur 450-460 Derajat Celcius, sehingga seluruh material terlapisi Zinc secara metarlurgi.



## DRYING

(Pengerinan)



This process is the process of drying the material so as not to cause explosions and sparks during the process of Dipping.

Proses ini adalah proses mengeringkan material agar tidak menimbulkan ledakan dan percikan pada saat proses Dipping.



## FLUXING

(Perlindungan awal terhadap karat)



This is the process of protect the material from oxidation rust and help the metallurgical Dipping during the process. This process uses Zinc Ammonium Chloride (to the surface).

Proses ini adalah melindungi material dari oksidasi karat dan membatu proses metalurgi pada saat proses Dipping. Proses ini menggunakan Zinc Ammonium Chloride (untuk bagian permukaan).

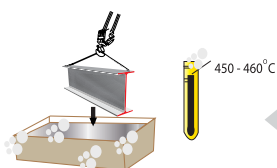

**Dipping (Pencelupan)**  
Proses Pencelupan material dalam cairan Zinc panas dengan temperatur 450-460° C

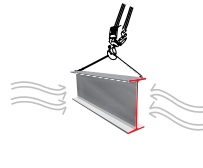

**Drying (Pengerinan)**  
Proses pengerinan material

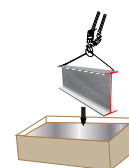

**Fluxing**  
Perlindungan awal terhadap karat dengan Zinc Ammonium Chloride



10 PACKING & LOADING







PACKING GALVANIZE



LOADING TRONTON



LOADING CONTAINER



LOADING TRUCK



WEIGHTING



QUALITY CONTROL LAB



LABORATORIUM BUILDING



TENSILE TEST



PROFILE PROJECTOR



GRINDA COLESING

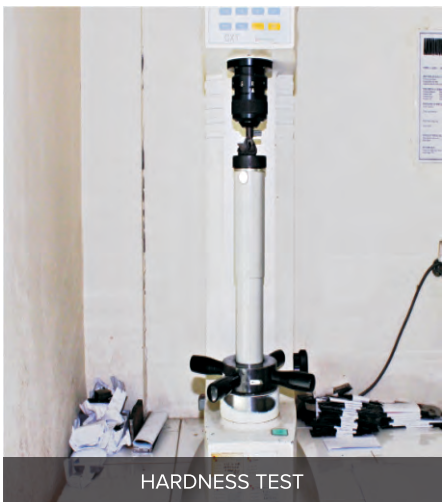

HARDNESS TEST

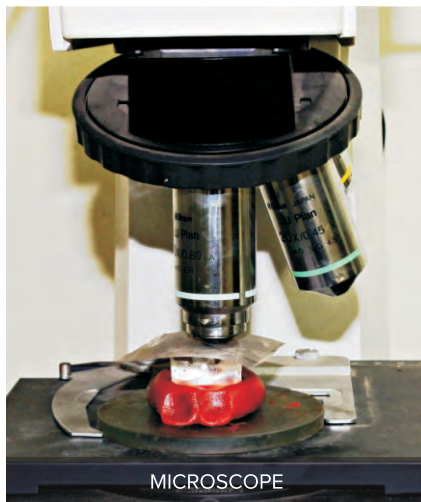

MICROSCOPE



CHARPY IMPACT







# STEEL BUILDING

## POWER PLANT - PROJECT -

Project Name : PLTU 2 x (300-400) MW  
Client Name : PT. Zelan Priamanaya Jo  
Tonnage : 15.266 MT  
Location | Year : Rembang, Central Java - Indonesia | 2008



## POWER PLANT BUILDING



Project Name : GEOTHERMAL POWER PLANT  
 Client Name : Pertamina - Hawkin - BCK  
 Tonnage : 300 MT  
 Location | Year : Tasikmalaya - West Java - Indonesia | 2016



Project Name : PLTGU PALEMBANG 150 MW  
 Client Name : PT. Asrigita Prasarana  
 Tonnage : 409 MT  
 Location | Year



Project Name : POWER PLANT 2X300 MW  
 Client Name : PT. Sumber Segara Primadaya  
 Tonnage : 500 MT  
 Location | Year : Cilacap, Central Java - Indonesia | 2005



Project Name : PLTU 150 MW - Coal Fired TeiSei  
 Client Name : Daiho Corporation  
 Tonnage : 520 MT  
 Location | Year : Mindano - Philipine | 2010



Project Name : PLTD SENAYAN  
 Client Name : PT. Wartsila - PT. PLN (Persero)  
 Tonnage : 2000 MT  
 Location | Year : Kupang, Papua, Jakarta - Indonesia | 2018



Project Name : PTIP PTA PLANT MODIFICATION  
 Client Name : PT Indorama Ventura  
 Tonnage : 450 MT  
 Location | Year : Cilegon, Banten - Indonesia | 2015



Project Name : CHEMICAL PLANT KPI  
 Client Name : PT. Cemara Semitama  
 Tonnage : 780 MT  
 Location | Year : Bontang, Kalimantan - Indonesia | 2000



# STEEL BUILDING

INDUSTRIAL  
- PROJECT -



Project Name : KAO CHEMICAL FACTORY  
Client Name : PT. Apical Kao Chemical  
Tonnage : 1755 MT  
Location | Year : Dumai, Riau - Indonesia | 2017



## INDUSTRIAL BUILDING



Project Name : CRUDE PALM OIL (CPO) MILL  
 Client Name : PT. Bumi Sarima Kelapa  
 Tonnage : 50 MT  
 Location | Year : Padang, West Sumatera - Indonesia | 2000



Project Name : CRUDE PALM OIL (CPO) BONTANG MILL  
 Client Name : PT. Polasihan Prima Lestari  
 Tonnage : 430 MT  
 Location | Year : Palembang, South Sumatera - Indonesia | 2000



Project Name : SANEX FACTORY  
 Client Name : PT. Sanex Qianjiang Motor Int.  
 Tonnage : 1.300 MT  
 Location | Year : Bekasi, West Java - Indonesia | 2000



Project Name : DEPO - PT. KAI DEPOK  
 Client Name : PT. Wijaya Karya  
 Tonnage : 829 MT  
 Location | Year : Depok, West Java - Indonesia | 2005



Project Name : WAREHOUSE  
 Client Name : Eco Tower Sdn. Bhd.  
 Tonnage : 3.800 MT  
 Location | Year : Malaysia | 2009



Project Name : FACTORY & WAREHOUSE GG3  
 Client Name : PT. Gunung Garuda  
 Tonnage : 600 MT  
 Location | Year : Bekasi, West Java - Indonesia | 2013



Project Name : FARMER BUILDING  
 Client Name : PT. Charoen Phokpand  
 Tonnage : 150 MT  
 Location | Year : Bogor, West Java - Indonesia | 2014



Project Name : PLASTIC FACTORY  
 Client Name : PT. Anta Tirta Kharisma  
 Tonnage : 800 MT  
 Location | Year : Sukabumi, West Java - Indonesia | 2017



# STEEL BUILDING

## COMMERCIAL - PROJECT -



Project Name : HARCO GLODOK  
Client Name : PT. Wahana Sentra Sejati  
Tonnage : 5.824 MT  
Location | Year : DKI Jakarta - Indonesia | 2015



## COMMERCIAL BUILDING



**Project Name** : THAMRIN NINE (Belt Truss & Outrigger)  
**Client Name** : PT. Putragaya Wahana  
**Tonnage** : 2550 MT  
**Location | Year** : DKI Jakarta - Indonesia | 2018



**Project Name** : INDONESIA ONE (Intermediate Beam)  
**Client Name** : JO CCED - PT. Acset Indonusa  
**Tonnage** : 1200 MT  
**Location | Year** : DKI Jakarta - Indonesia | 2019



# STEEL BRIDGE

ARCH, GIRDER & TRUSS  
- PROJECT -



Project Name : JEMBATAN MERAH PUTIH  
Client Name : PT. Waskita - PP - Wika KSO  
Tonnage : 2.200 MT  
Location | Year : Maluku, Ambon - Indonesia | 2013



## STEEL BRIDGE



**Project Name** : SMITH BRIDGE (Temporary Jetty)  
**Client Name** : Chuan Eu International  
**Tonnage** : 500 MT  
**Location | Year** : Australia | 2009



**Project Name** : JEMBATAN RANGKA (TRUSS) Type A40m  
**Client Name** : PT. Modern Surya Jaya  
**Tonnage** : 97 MT  
**Location | Year** : Surabaya, East Java | 2002



**Project Name** : JEMBATAN KERETA API  
**Client Name** : PT. Istana Putra Bangun  
**Tonnage** : 125 MT  
**Location | Year** : Semarang, Central Java | 2002



**Project Name** : JEMBATAN RANGKA (TRUSS) STANDARD  
Type A60m, A55m, A50m, A40m, B60m, B45m - APBN 2009  
**Client Name** : Departemen Pekerjaan Umum Republik Indonesia  
**Tonnage** : 1.423 MT  
**Location | Year** : DKI Jakarta | 2009



**Project Name** : CABLE STAY B-45 PADANG  
**Client Name** : Dinas PU Padang  
**Tonnage** : 40 MT  
**Location | Year** : Padang, West Sumatera | 2009



# STEEL BRIDGE

ARCH, GIRDER & TRUSS  
- PROJECT -

Project Name : LRT PALEMBANG  
Client Name : PT. Waskita Karya (Persero) Tbk.  
Tonnage : 6.300 MT  
Location | Year : Palembang, Sumatera - Indonesia | 2017





Project Name : JEMBATAN PELENGKUNG A-70  
 Client Name : PT. Dinamik  
 Tonnage : 283 MT  
 Location | Year : DKI Jakarta - Indonesia | 2017



Project Name : JEMBATAN PELENGKUNG A-128  
 Client Name : PT. Fajar Parahyangan  
 Tonnage : 600 MT  
 Location | Year : Bojonegoro, Central Java - Indonesia | 2006



Project Name : JEMBATAN PELENGKUNG A-165  
 Client Name : Dinas PU Tanjung Jabung Timur  
 Tonnage : 1.853 MT  
 Location | Year : Muara Sabak, Jambi - Indonesia | 2009



Project Name : JEMBATAN PELENGKUNG A-250  
 Client Name : PT. Waskita Karya  
 Tonnage : 2.750 MT  
 Location | Year : Teluk Masjid, Riau - Indonesia | 2007



Project Name : JEMBATAN PELENGKUNG A-128  
 Client Name : PT. Jatisono Multi Konstruksi  
 Tonnage : 1.423 MT  
 Location | Year : Lumajang, East Java | 2012



Project Name : PROTOTYPE JEMBATAN CABLE STAYED  
 Client Name : PT Waskita Karya Wilayah Tengah  
 Tonnage : 206 MT  
 Location | Year : Sukabumi, West Java - Indonesia | 2009



Project Name : JEMBATAN PELENGKUNG A-150  
 Client Name : PT. Swakarya Jaya  
 Tonnage : 1.602 MT  
 Location | Year : Palangkaraya, Central Kalimantan | 2012



# STEEL TOWER

- PROJECT

Project Name : TRANSMISSION TOWER  
Client Name : PT. PLN Persero  
Tonnage : 4.914 MT  
Location | Year : Sumatera, Kalimantan, Central Java | 2019



## STEEL TOWER



**Project Name** : MONUMENT TOWER GORONTALO  
**Client Name** : Pemerintah Daerah Pedago  
**Tonnage** : 330 MT  
**Location | Year** : Gorontalo, Sulawesi - Indonesia | 2002



**Project Name** : TELECOMMUNICATION TOWER  
**Client Name** : PT. Gunung Steel Group  
**Tonnage** : 94 MT  
**Location | Year** : Cibitung, Bekasi, West Java - Indonesia | 2000



**Project Name** : RADIO TOWER  
**Client Name** : Alan Dick & Co. Ltd  
**Tonnage** : 104MT  
**Location | Year** : Jakarta - Indonesia | 2009



**Project Name** : COMMUNICATION TOWER (28)  
**Client Name** : PT. Indotech Jaya Lestari  
**Tonnage** : 495 MT  
**Location | Year** : DKI Jakarta - Indonesia | 2002



**Project Name** : COMMUNICATION TOWER (28)  
**Client Name** : PT. Duta Sembilantama Kreasindo  
**Tonnage** : 526 MT  
**Location | Year** : DKI Jakarta - Indonesia | 2001



## STEEL TOWER



**Project Name** : TOWER INDOSAT  
**Client Name** : PT. Bahayutama Kerta Mukti  
**Tonnage** : 94 MT  
**Location | Year** : Jakarta - Indonesia | 2002



**Project Name** : SUBSTATION TOWER  
**Client Name** : PT. Listrindo  
**Tonnage** : 21 MT  
**Location | Year** : Bandung, West Java - Indonesia | 2006



**Project Name** : TELECOMMUNICATION TOWER  
**Client Name** : PT. Bahayutama Kerta Mukti  
**Tonnage** : 46 MT  
**Location | Year** : Jakarta - Indonesia | 2003



**Project Name** : TRANSMISSION TOWER 150 & 500 KV  
**Client Name** : PT. PLN (Persero) Pikitring JBN  
**Tonnage** : 14.000 MT  
**Location | Year** : Semarang, Central Java - Indonesia | 2003



**Project Name** : TRANSFER TOWER  
**Client Name** : PT. Semen Cibinong  
**Tonnage** : 104 MT  
**Location | Year** : Cibinong, Bogor, West Java - Indonesia | 2006



**Project Name** : TRANSMISSION TOWER 500 KV  
**Client Name** : PT. PLN (Persero) Pikitring JBN  
**Tonnage** : 2.750 MT  
**Location | Year** : Tasikmalaya, West Java - Indonesia | 2007



**Lloyd's Register**

### Certificate of Approval

This is to certify that the Management System of  
**PT. Gunung Baja Konstruksi**  
 Kp. Tangsi, RT 004/006/II, Ds. Sukadanau, Cikarang Barat, Bekasi, Jawa Barat, 17520 Indonesia  
 has been approved by LRQA to the following standards:  
 ISO 9001:2015

*Basem Obaid*  
 Basem Obaid - Global Head of Training and Improvement Services  
 Issued by: FT, Lloyd's Register Indonesia

Current issue date: 17 January 2019  
 Expiry date: 17 December 2021  
 Certificate identity number: 10'86026

Original approval:  
 ISO 9001 - 18 December 2012

Approval number: ISO 9001 - 3044543

The scope of this approval is applicable to:  
 Design and Fabrication of ranges of steel structures for commercial and industrial buildings, towers and bridges. Provision of hot dip metal galvanizing.

**KAN**  
 Komite Akreditasi Nasional  
 Lembaga Sertifikasi Sistem Mutu  
 ISSM - 051 - IDN

**Lloyd's Register**

### Certificate of Approval

This is to certify that the Management System of  
**PT. Gunung Baja Konstruksi**  
 Kp. Tangsi, RT 004/006/II, Ds. Sukadanau, Cikarang Barat, Bekasi, Jawa Barat, 17520 Indonesia  
 has been approved by LRQA to the following standards:  
 ISO 9001:2015

*Basem Obaid*  
 Basem Obaid - Global Head of Training and Improvement Services  
 Issued by: FT, Lloyd's Register Indonesia  
 for and on behalf of: Lloyd's Register Quality Assurance Limited

Current issue date: 17 January 2019  
 Expiry date: 17 December 2021  
 Certificate identity number: 10'86027

Original approval:  
 ISO 9001 - 18 December 2012

Approval number: ISO 9001 - 3044543

The scope of this approval is applicable to:  
 Design and Fabrication of ranges of steel structures for commercial and industrial buildings, towers and bridges. Provision of hot dip metal galvanizing.

**UKAS**  
 MANAGEMENT SYSTEMS  
 001

**TUV NORD**  
 Indonesia

## CERTIFICATE

Management System as per  
**ISO 14001 : 2015**

In accordance with TUV NORD Indonesia procedures, it is hereby certified that

**PT. GUNUNG BAJA KONSTRUKSI**  
 Kp. Tangsi RT.004/006/II/ Ds. Sukadanau  
 Kec. Cikarang Barat, Kabupaten Bekasi 17520  
 Jawa Barat - Indonesia

applies a management system in line with the above standard for the following scope  
**Design and Fabrication of a Range of Steel Structures for Commercial and Industrial Buildings, Towers and Bridges**

Certificate Registration No. 08.04.J.16080  
 Audit Report No. I-2180500218  
 Valid until 2019-10-26  
 Initial Certification 2016-10-20

*Basem Obaid*  
 TUV NORD Indonesia Certification Body  
 TUV NORD Group  
 Jakarta, 2018-09-20

This certification was conducted in accordance with the TUV NORD Indonesia auditing and certification procedures and is subject to regular surveillance audits.

PT TUV NORD Indonesia, Petaharjoan Hajar Akhadi Tower F 7th floor, Jl. Lat. Jend. T.B. Simatupang Kav. 68, Jakarta Selatan 12522

**KAN** **IAF**

149818 ID 16080.8A2

**Certificate of Registration**

This is to certify that compliance of Occupational Health and Safety Management System of  
**PT. GUNUNG BAJA KONSTRUKSI**  
 Kp. Tangsi Rt. 004/006/II  
 Desa Sukadanau Kec. Cikarang Barat  
 Bekasi 17520 - Jawa Barat

Has been assessed and found to conform to the requirement of  
**OHSAS 18001 : 2007**

For the scope of activities  
**Design And Fabrication Of A Range Of Steel Structures For Commercial And Industrial Buildings, Tower And Bridges**

Certificate No. : RO62/JA/2147  
 JAS-ANZ Accreditation No. : M44303101C  
 Issue Date : 11.08.2017  
 Certificate Valid Upto : 10.08.2020

**JAS-ANZ**  
 www.jas-anz.org / register

Quality Seal  
 For and on behalf of Quest Certification (P) Ltd

Surveillance Audit : 2nd Year : 07.08.2018  
 3rd Year : 07.08.2019  
 The certificate is valid only if the annual surveillance work is present.

*Basem Obaid*  
 Head of Certification

The validity of this Certificate can be verified from [www.questcertification.com](http://www.questcertification.com)  
 The Registration does not assure the quality of yields under the firm's production / services

**Quest Certification (P) Ltd**  
 Regd Office: Plot No. 44, Door No. 4, 4th Cross Street, NGO Colony, Adambakkam, Chennai - 68, Tamil Nadu, India  
 Accredited by Joint Accreditation System of Australia and New Zealand ([www.jas-anz.org](http://www.jas-anz.org) / register)

**KEMENTERIAN LINGKUNGAN HIDUP DAN KEHUTAN  
 REPUBLIK INDONESIA**

MENYANUGERAHKAN PENGHARGAAN  
 PROGRAM PENILAIAN PERINGKAT KINERJA PERUSAHAAN  
 DALAM PENGELOLAAN LINGKUNGAN HIDUP

**PROPER**  
 PERINGKAT  
**BIRU**

KEPADA  
**PT. Gunung Steel Construction**  
 PERIODE 2016 - 2017

*Basem Obaid*  
 Direktur Jenderal Pengendalian Pencemaran dan Kerusakan Lingkungan





PROJECT NAME	CLIENT NAME	TONNAGE	LOCATION	YEAR
<b>STEEL BUILDING PROJECT</b>				
Chemical Plant KPI	PT. Cemara Semitama	780 MT	Bontang, Kalimantan	2000
Sanex Factory	PT. Sanex Qianjiang Motor Int.	1.300 MT	Bekasi, West Java	2000
PLTGU Palembang 150 MW	PT. Asrigita Prasarana	409 MT	Palembang, South Sumatera	2003
Depo - PT. KAI Depok	PT. Wijaya Karya	829 MT	Depok, West Java	2005
Power Plant 2 X 300 MW	PT. Sumber Segara Primadaya	500 MT	Cilacap, Central Java	2005
Factory & Warehouse Gloves	PT. First International Gloves	1.400 MT	Kalimantan	2007
PLTU 2 X 300-400 MW	PT. Zelan Priamanaya Jo	15.266 MT	Rembang, Central Java	2008
Warehouse	ECO Tower Sdn. Bhd.	3.800 MT	Malaysia	2009
Power Plant 150 MW Coal Fired Tei Sei	Daiho Corporation	520 MT	Mindanao, Philipines	2010
Factory & Warehouse GG3	PT. Gunung Garuda	600 MT	Bekasi, West Java	2013
Pirelli	Leighton Contractor Indonesia	994 MT	Subang, West Java	2013
Tekwang Project	Samhwan Corporation	983 MT	Kalimantan	2013
Farmer Building	PT. Charoen Pokphan Indonesia	96 MT	Bogor, West Java	2014
Chemical Building	PT. Indorama Ventures	450 MT	Cilegon, Banten	2015
Harco Glodok	PT. Wahana Sentra Sejati	5.824 MT	Glodok, Jakarta	2015
King Post	PT. Astra Internasional Tbk	1500 MT	DKI Jakarta	2015
Geothermal Power Plant	PT. Pertamina - Hawkin - BCK	300 MT	Tasikmalaya, West Java	2016
Plastic Factory	PT. Anta Tirta Kharisma	3.050 MT	Sukabumi, West Java	2017
Kao Chemical Factory	PT. Apical Kao Chemical	1755 MT	Dumai, Riau	2017
Thamrin Nine - Belt Truss & Outrigger	PT. Putra Gaya Wahana	2550 MT	Thamrin, Jakarta	2018
PLTD & Gas Engine - Power Plant	PT. Wartsila	300 MT	Kupang, Papua, Jakarta	2018
Indonesia One - Intermediate Beam	JO CCED - PT. Acset Indonusa	1200 MT	DKI Jakarta	2019
Lapangan Tembak	Brimob Polda Lampung	85 MT	Lampung	2019
<b>STEEL BRIDGE PROJECT</b>				
Jembatan Rangka Truss Type A40M	PT. Modern Surya Jaya	97 MT	Surabaya, East Java	2002
Jembatan Kereta Api	PT. Istana Putra Bangun	125 MT	Semarang, Central Java	2002
Jembatan Pelengkung A128M	PT. Fajar Parahyangan	600 MT	Bojonegoro, Central Java	2006
Jembatan Rangka Truss A40-B60	Dinas PUPR	1.423 MT	DKI Jakarta	2009
Smith Bridge (Temporary Jetty)	Chuan Eu International	500 MT	Australia	2009
Cable Stay B-45 Padang	Dinas PUPR Padang	40 MT	Padang, West Sumatera	2009
Jembatan Pelengkung A150M	PT. Swakarya Jaya	1.602 MT	Palangkaraya, Kalimantan	2012
Jembatan Merah Putih	PT. Waskita - PP - Wika KSO	2.200 MT	Maluku, Ambon	2013
LRT Palembang (Bridge & Station)	PT. Waskita Karya Persero Tbk	6.300 MT	Palembang, South Sumatera	2017
Jembatan Rangka Truss	Dinas PUPR	2.000 MT	DKI Jakarta	2019
<b>STEEL TOWER PROJECT</b>				
Telecommunication Tower	PT. Gunung Steel Group	94 MT	Bekasi, West Java	2000
Communication Tower 2B	PT. Duta Sembilantama Kreasindo	526 MT	DKI Jakarta	2001
Comunicatoin Tower 2B	PT. Indotech Jaya Lestari	495 MT	DKI Jakarta	2002
Monument Tower Gorontalo	Pemerintah Daerah Pedago	330 MT	Gorontalo, Sulawesi	2002
Tower Indosat	PT. Bahyutama Kerta Mukti	94 MT	DKI Jakarta	2002
Telecommunication Tower	PT. Bahyutama Kerta Mukti	46 MT	DKI Jakarta	2003
Transmission Tower 150 - 500 KV	PT. PLN (Persero) Pikitring JBN	14.000 MT	Semarang, Central Java	2003
Substation Tower	PT. Listrindo	21 MT	Bandung, West Java	2006
Transfer Tower	PT. Semen Cibinong	104 MT	Bogor, West Java	2006
Transmission Tower 500 KV	PT. PLN (Persero) Pikitring JBN	2.750 MT	Tasikmalaya, West Java	2007
Transmission Tower 150 - 500 KV	PT. PLN (Persero) Pikitring JBN	4.914 MT	Sumatera, Kalimantan, Central Java	2019



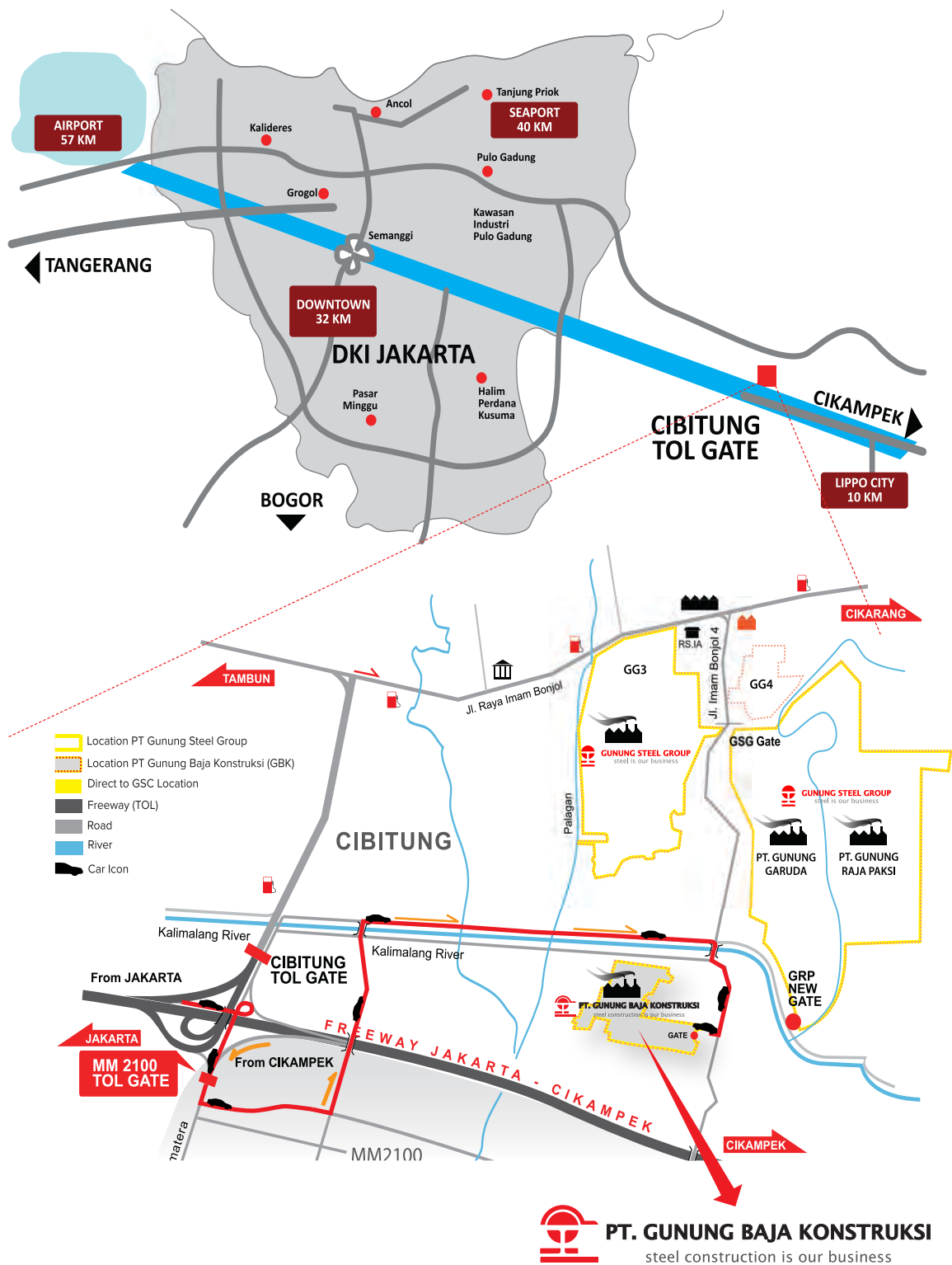



## DISTRIBUTION MAP



**PT. GUNUNG BAJA KONSTRUKSI**

steel construction is our business

### Head Office & Plant

GBK Building, Jl. Raya Jarakosta  
Prapatan Ne'ih, RT. 007 / 004 Sukadanau  
West Cikarang – Bekasi 17530  
West Java – INDONESIA

Phone : (021) 8983 8121  
Fax : (021) 8910 8031  
Email : [sales.gsc@grdsteel.com](mailto:sales.gsc@grdsteel.com)  
[sales.gsc-efc@grdsteel.com](mailto:sales.gsc-efc@grdsteel.com)  
[sales.gsc-galv@grdsteel.com](mailto:sales.gsc-galv@grdsteel.com)

[www.gunungbaja.com](http://www.gunungbaja.com)